

FORM No. 1.

Thomas Brassey

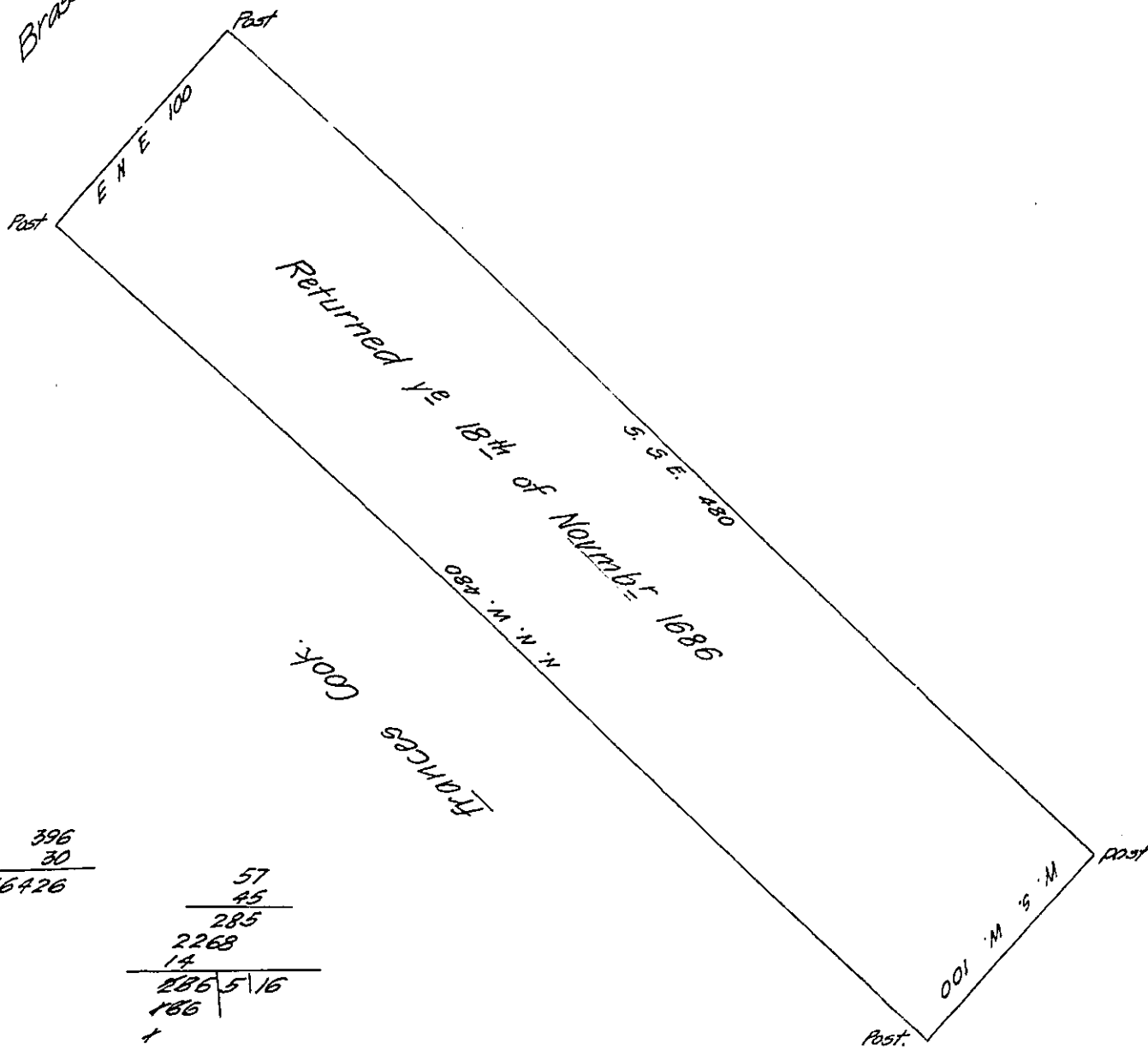

396
30
16426

57
45
285
2268
14
226516
186
+

Thomas ducket 300 acres of Land

Liang on ridly Creek Surveyed P. Charles Ashcom

May the 29: 1685.

Com: war: dated ye 26th of ye 3d 1685.

IN TESTIMONY that the above is a copy of the original remaining on file in the Department of Internal Affairs of Pennsylvania, made conformably to an Act of Assembly approved the 16th day of February, 1833, I have hereunto set my Hand and caused the Seal of said Department to be affixed at Harrisburg, this twentieth day of May 1909

Nancy Howell
 Secretary of Internal Affairs.